



8 The Causeway | | Chorley | PR6 0TY

This well-presented two-bedroom semi-detached property offers the perfect blend of comfort, convenience, and modern living. Ideally situated in a highly popular residential area, the home is within easy reach of local shops, excellent schools, transport links, and nearby amenities making it an ideal choice for first-time buyers, young families, or downsizers. The property features a bright and spacious lounge, a modern fitted kitchen, and two generous bedrooms, along with a well-appointed family bathroom. Outside, you'll find a private rear garden perfect for relaxing or entertaining and ample off-road parking to the front. With its desirable location and well-maintained accommodation throughout, this property is not to be missed.

Guide Price £180,000

- Popular Residential Location
- Two Bedroom Modern Style House
- Spacious Lounge
- Kitchen/Diner
- Two Double Bedrooms

GROUND FLOOR

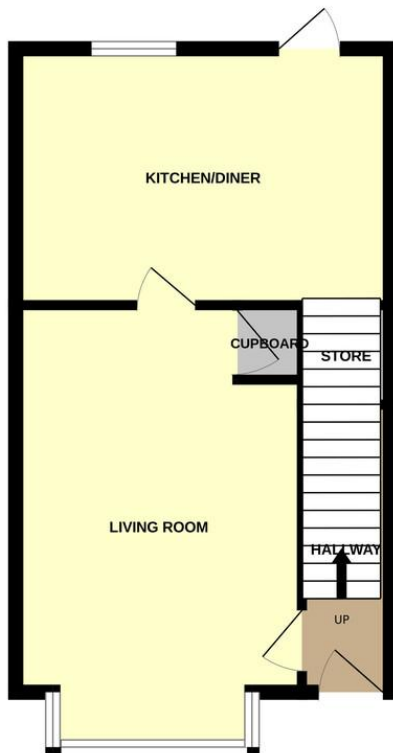

1ST FLOOR



Contact Details

Redrose
15 Barnes Wallis Way
Budshaw Village
Chorley
Lancs
PR7 7JA

www.redrosepm.co.uk
sales@redrose.co.uk
01772 456558

%epcGraph_c_1_349%

Agents Note: Whilst every care has been taken to prepare these sales particulars, they are for guidance purposes only. All measurements are approximate and are for general guidance purposes only and whilst every care has been taken to ensure their accuracy, they should not be relied upon and potential buyers are advised to recheck the measurements